

Model SA111-xxxWD/PD

SA111 DATASHEET
(Rev A / 19.Feb.2020)

Sh 1 of 2

UNITS IN INCHES [mm]

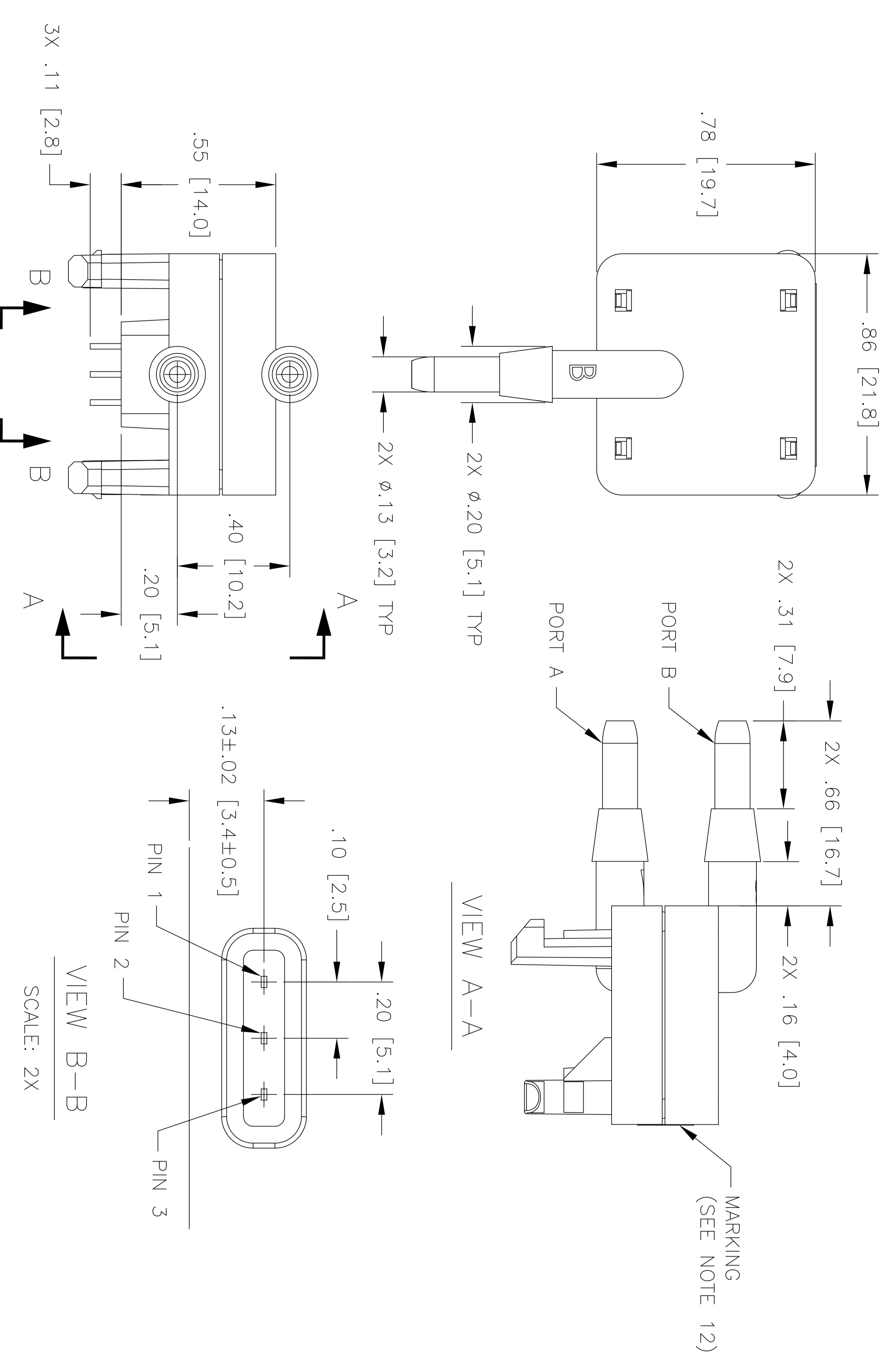

NOTES

- SPAN IS DEFINED AS THE ALGEBRAIC DIFFERENCE BETWEEN THE ELECTRICAL OUTPUT AT FULL SCALE PRESSURE AND THE ELECTRICAL OUTPUT AT ZERO PRESSURE.
- TEMPERATURE RANGE 0°C TO 60°C WITH RESPECT TO 25°C.
- APPROXIMATE TILT ERROR FROM VERTICAL TO HORIZONTAL POSITION.
- FOR FUNCTIONALITY, PARTS ARE CALIBRATED AT 5.0±.003V.
- 10mSEC MAX @ 25°C FOR OUTPUT TO REACH 63% FSO WITH STEP INPUT.
- DC TO 1 KHZ.
- AT NO LOAD CONDITION.
- PROOF PRESSURE EFFECT: ±0.25% SPAN MAXIMUM ON ZERO AND SPAN FOLLOWING APPLICATION OF PROOF PRESSURE.
- VIBRATION LIMITS: 10G SINUSOIDAL PER MIL-STD-810C, PROCEDURE 514.2-2, CURVEL.
- VIBRATION EFFECT: ±0.25% SPAN MAX ON ZERO & FSO WITH NO RESONANCE WITHIN SPECIFIED LIMITS.
- SHOCK LIMITS: 50G, 11mSEC, 1/2 SINE PER MIL-STD-202F, METHOD 213B, CONDITION A.
- SHOCK EFFECT: ±0.25% SPAN MAXIMUM ON ZERO AND FSO WITHIN SPECIFIED LIMITS.
- HUMIDITY LIMITS: 95%RH, NON-CONDENSING ENVIRONMENT.
- HUMIDITY EFFECT: ±0.10% SPAN ON ZERO AND FSO WITHIN SPECIFIED LIMITS.
- DEVICE MARKING: EACH DEVICE IS MARKED COMPLETE WITH MODEL NUMBER, LOT NUMBER AND SERIAL NUMBER (LLLL SSSS), AND DATE CODE (YYWW)

SPECIFICATIONS FOR 'PORT A' PRESSURE INPUT,
SUPPLY VOLTAGE: 5 VDC; AMBIENT TEMPERATURE: 25°C (UNLESS OTHERWISE SPECIFIED)

PARAMETERS	MIN	TYP	MAX	UNITS	NOTES
ZERO OFFSET	SA110	.450	.500	.550	V
	SA111	.200	.250	.300	
	SA110	3.975	4.000	4.025	
SPAN	SA111	3.725	3.750	3.775	V
	SA110	4.425	4.500	4.575	
	SA111	3.925	4.000	4.075	
FULL SCALE OUTPUT	-	-	-	±1.5	% SPAN
TEMPERATURE ERROR, SPAN	-	-	-	2	% SPAN
TILT ERROR	-	-	-	±0.25	% SPAN
NON-LINEARITY (BFSL)	-	-	-	±0.10	% SPAN
HYSTERESIS AND REPEATABILITY	-	-	-	5.25	V
SUPPLY VOLTAGE	4.75	5.00	5.25	10	SEC
WARM-UP TIME	-	-	-	10	mSEC
RESPONSE TIME	-	-	-	50	UV P-P
OUTPUT NOISE	-	-	-	8	Ω
DC OUTPUT IMPEDANCE	-	-	-	2.9	mA
INPUT SUPPLY CURRENT	25	-	-	-	KΩ
MAXIMUM LOAD	-	-	-	3	PSI
LONG TERM STABILITY	-	±0.10	-	-	% SPAN/YR
PROOF PRESSURE	-	-	-	10	PSI
BURST PRESSURE	-	-	-	10	G
MECHANICAL VIBRATION	-	-	-	50	GH
MECHANICAL SHOCK	-	-	-	95%	RH
HUMIDITY	-	-	-	100	°C
OPERATING TEMPERATURE RANGE	-50	-	125	-	°C
STORAGE TEMPERATURE RANGE	-50	-	125	-	°C
MEDIA	CLEAN AIR OR INERT GAS				
WEIGHT	5.5 GRAMS				
HOUSING MATERIALS	NYLON				

PIN NO	FUNCTION
1	Vin
2	GROUND
3	Vout

PIN NO	FUNCTION	PRESSURE RANGES
1	Vin	001PD
2	GROUND	005WD
3	Vout	010WD
		015WD

Model SA11-XXXWD/PD

SA11 DATASHEET
(Rev A / 19.Feb.2020)
Sh 2 of 2

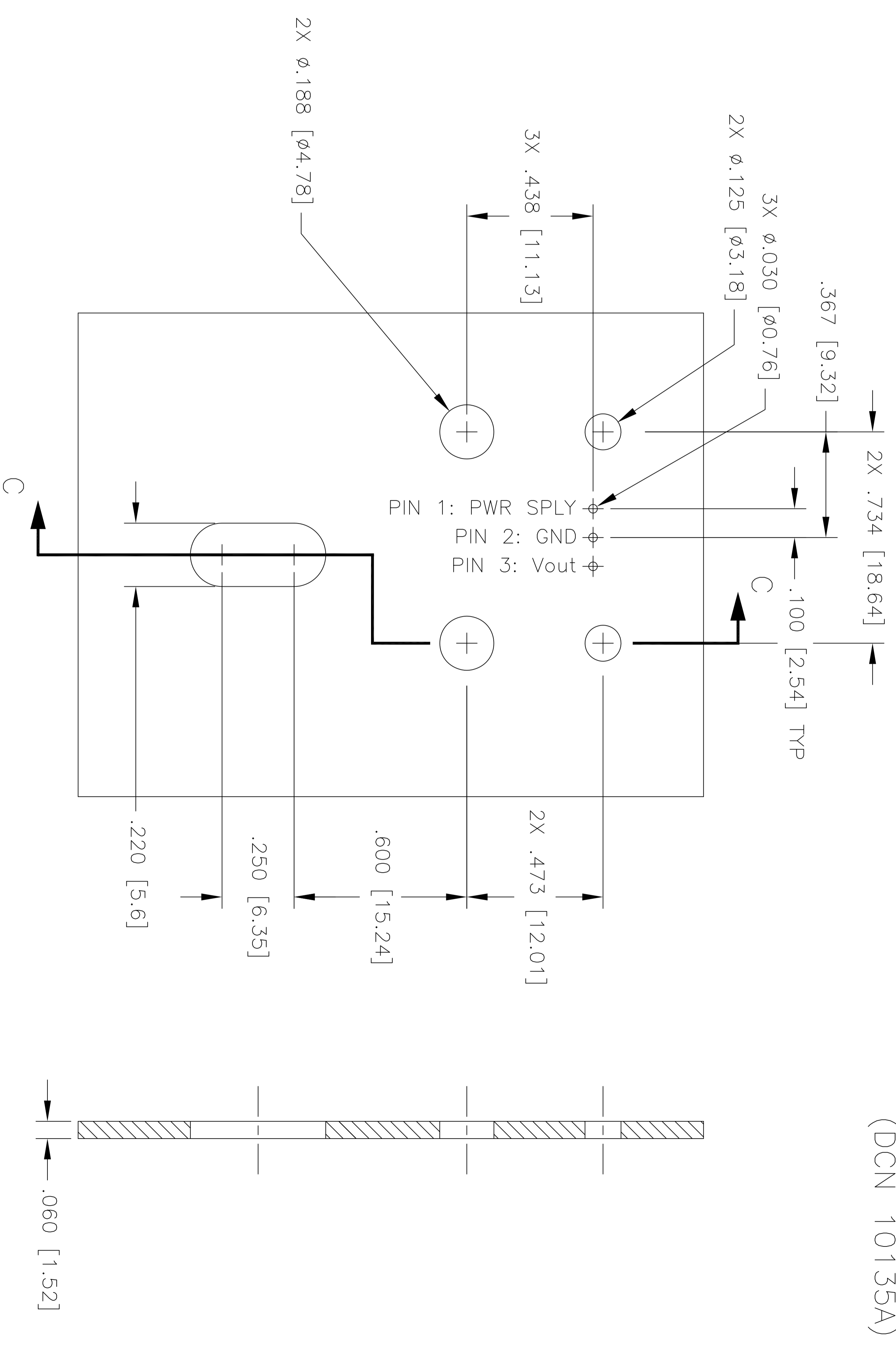
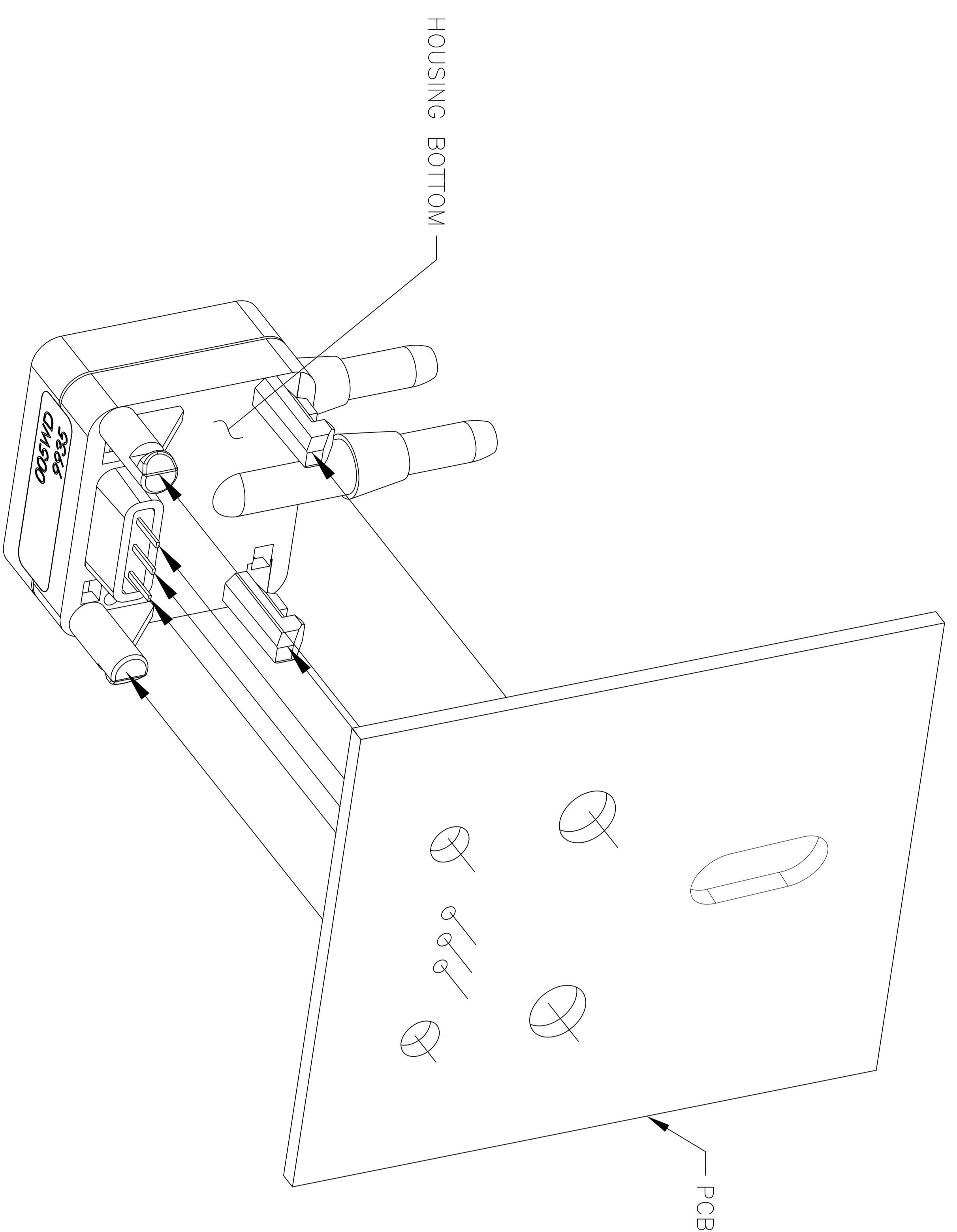

CIRCUIT BOARD HOLE PATTERN
(COMPONENT SIDE)

SECTION C-C

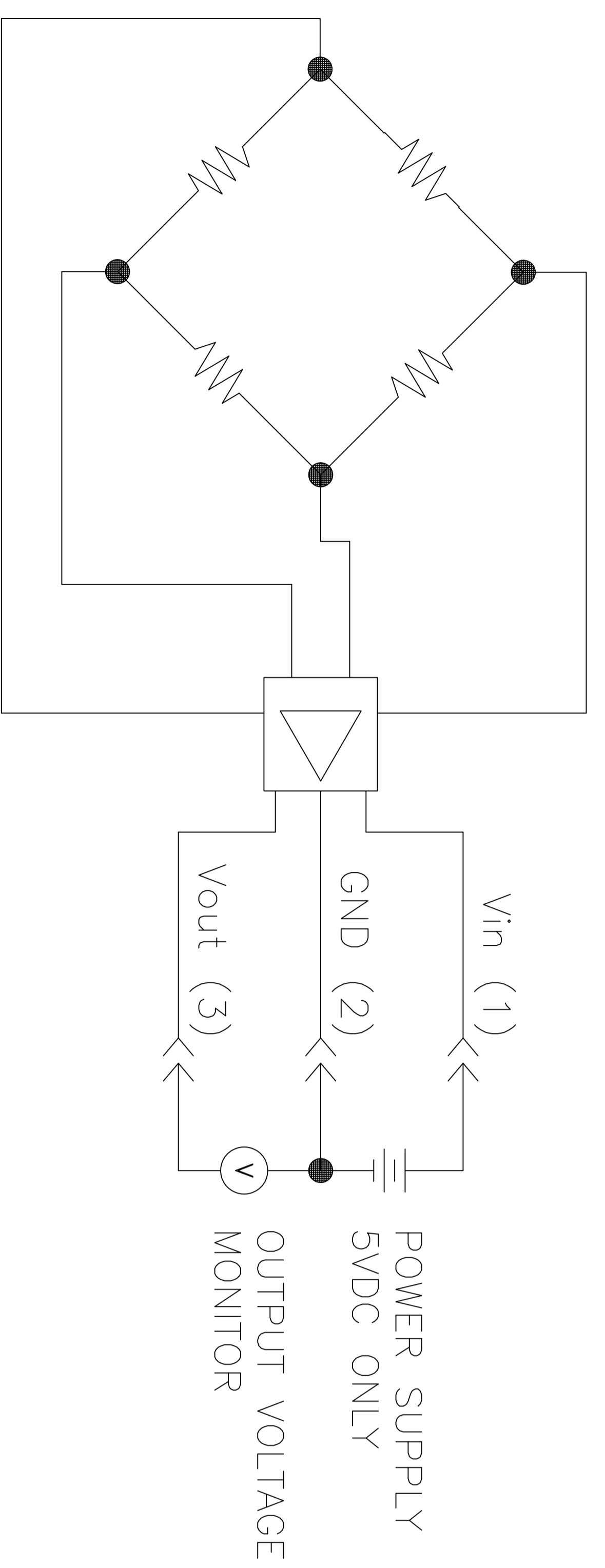

APPLICATION SCHEMATIC

ORDERING INFORMATION

